



***Even  
from there  
you can  
take care  
of your place  
with safety***



**aGenius**  
THE FUTURE IS WIRELESS

TECHNICAL INSTRUCTIONS

**aliberti®**

## aGenius brings the smart home in your hands.

The new system of wireless control of your electrical installation, offers comfort and security, while saving time, money and energy. It simplifies your daily life, with cybernated and "smart" operations, giving you the ultimate control of your place. Within minimum time and very low cost, a Genius constitutes your ally to a better way of life.

## Installation – The electrical installation is simplified.

### TRADITIONAL INSTALLATION

Wall chiselling  
Flexible tube & installation box  
Fettling - cleaning  
Install cables  
Mount switch

**Total time: 2½ hours**

### INSTALLATION WITH aGenius

Remove switch  
Glue RF switch onto the wall  
Install actuator  
Program actuator  
Save settings - close program mode

**Total time: 15 min**

## Transport of Signals Without Interferences

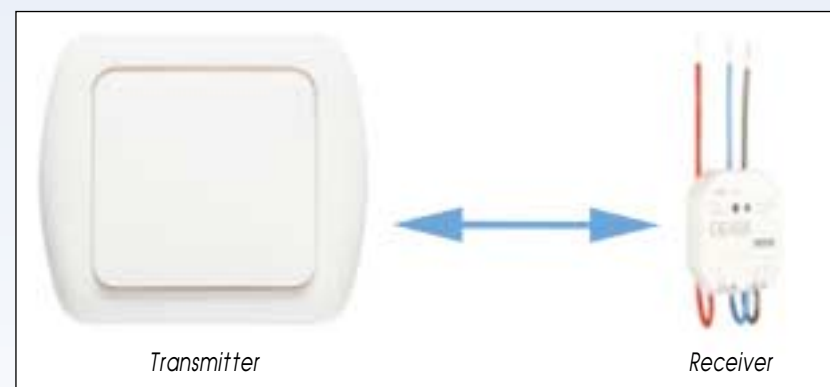

The system is operating in frequency of 868.3 MHz, with big reliability of transmission of signals.

It should be emphasized that any type of interferences is minimised, since every component of the system is unitary and the commands are bidirectional.

The transmitter sends a command to the actuator, which asks confirmation for the signal received. Only after receiving the confirmation, the actuator is executing the command. This way the impermeability of the installation is ensured.

## Unlimited Scope

According to the penetrability of the various structural units, the transmitter's scope of the signal varies from 30 to 50m inside a building, while it can reach up to 300m.

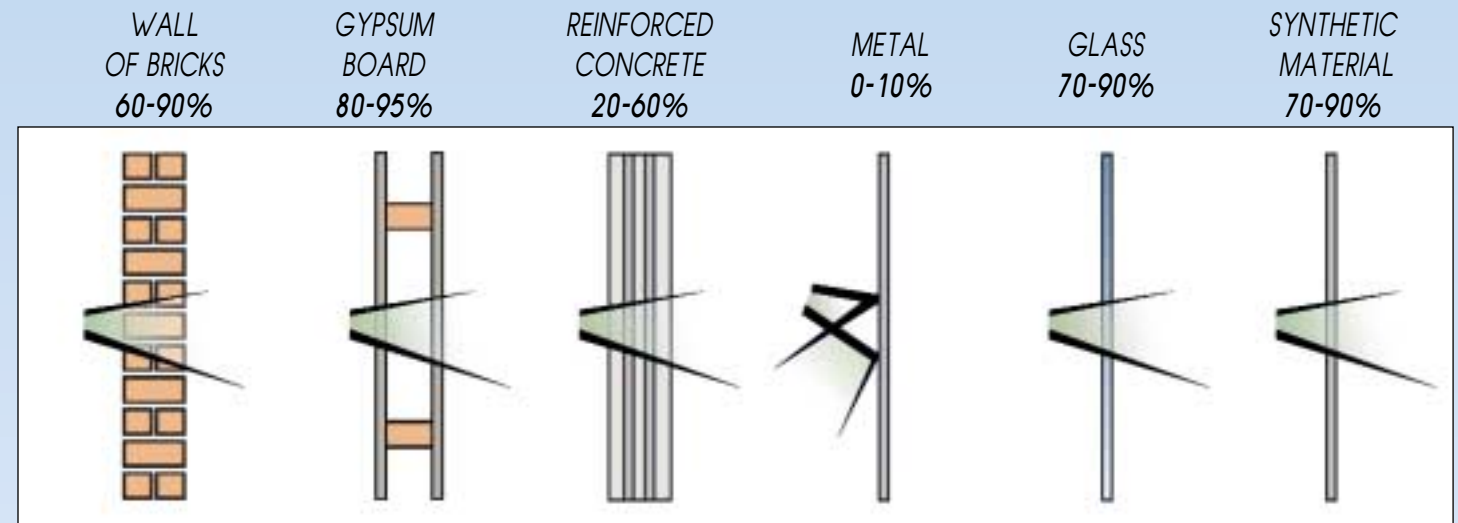

Of course, the scope can become unlimited with the procedure of routing.

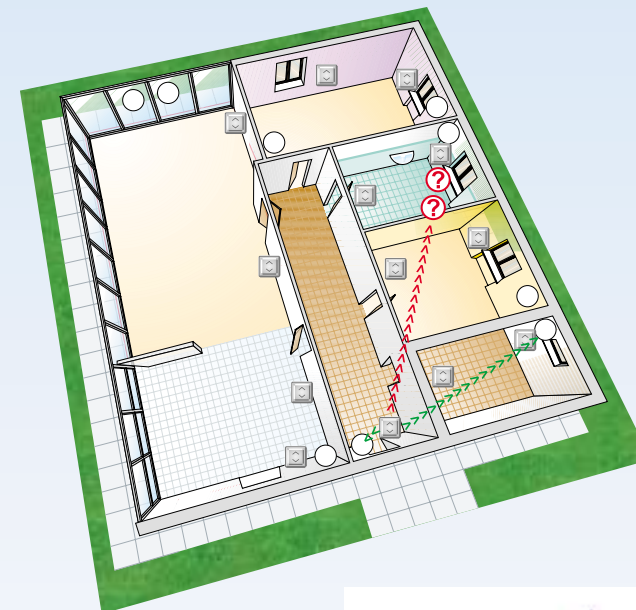

### Commands to unlimited transmitters.

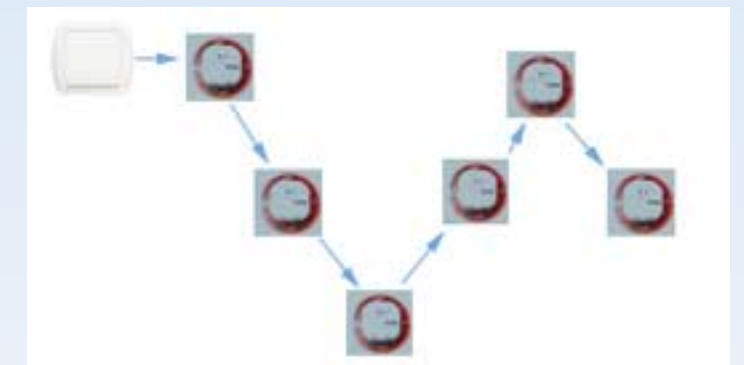

With the use of more than one actuator, the signal of the transmitter can be transmitted from actuator to actuator, until it reaches the final acceptor.

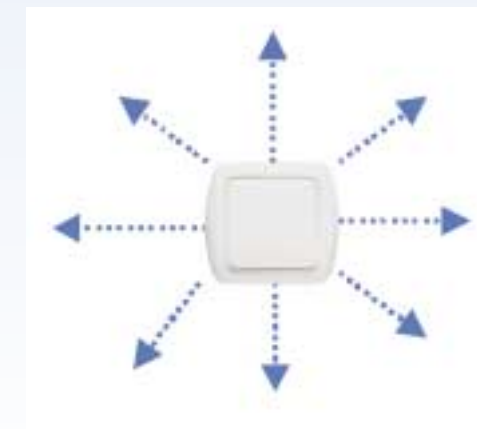

Every transmitter can send commands to unlimited actuators, while every actuator can accept commands from 15 different points-transmitters.

## Basic Version of aGenius

Depending on your requirements, you have the possibility to choose between the basic and the comfort version of the new RF system.  
In the basic version the only tool required is a screwdriver, with which you simply program the actuator to perform the predefined commands.

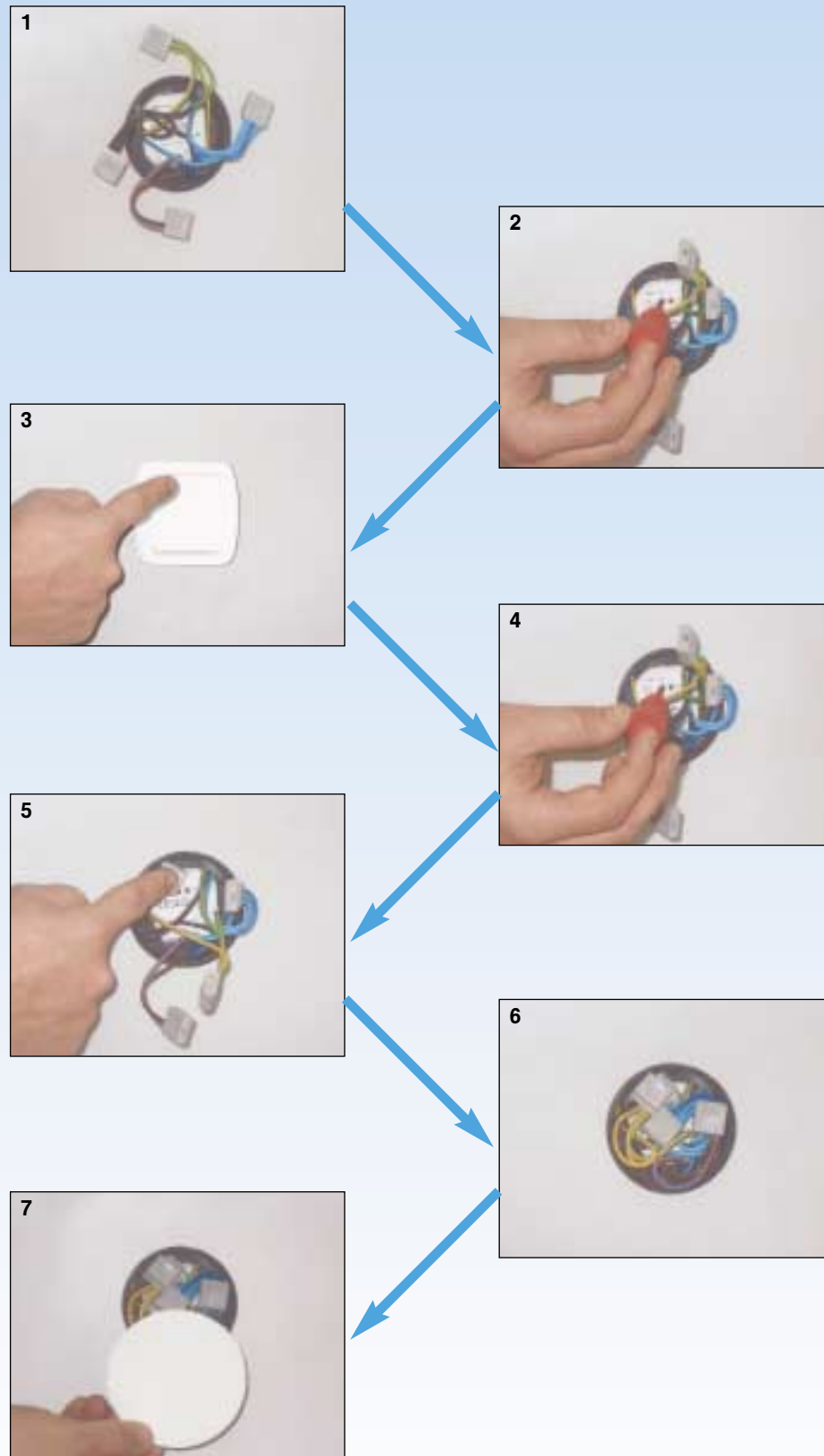

When you place and connect the actuator in the corresponding consumption, you press its program button, to start programming its memory.  
Then, you press the button of the switch / transmitter (remote control, thermostat etc.) from which you want to receive the command and finally you press the program button of the actuator again, in order to save the settings.

## Comfort Version of aGenius

At the comfort version, the possibilities provided and the choices of the controlled operations of devices are much more.  
The only thing required is an interface device (RS232), with which the readout and programming of the wireless elements is achieved.



Firstly, you place and connect the actuators to corresponding consumptions. The programming and all settings are now made with the help of a simple software program, in Greek / English menu, which runs in windows environment. After starting programming, a code number is required, aiming to secure the specific installation program. During the reading (scanning) procedure,



we also approach the unfavourable places of the wireless elements with the laptop, aiming at their complete recording. All actuators initially and then the battery devices ( transmitters), which are used in the aGenius installation, are recorded. The connections are made in a simple way.



Dragging the mouse, you connect the transmitters with the actuators with simple lines.

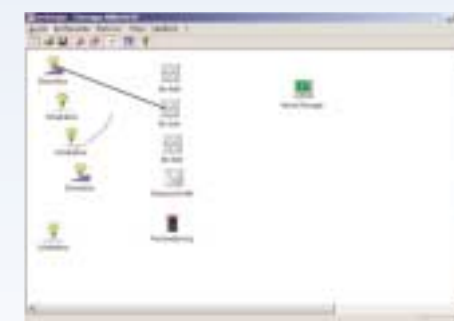

With the appropriate settings to the actuators and the transmitters, many and different operations can be achieved.  
The installation is completed when all the desirable settings are saved.

## Installation of actuators inside installation boxes, rosettes, drops ceilings e.t.c.



The actuators' small dimensions permit their placement inside installation boxes, rosettes of lightings, drop ceilings or even directly before any consumption. This fact simplifies even more the electrical installation, which can be modified at any moment.

## Ways of installation



Stick or screw the switch, thermostat e.t.c. on any surface.



Incorporation of conventional switches to the wireless system.

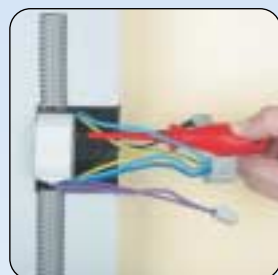

Either screw pins or clemmens can be used.



Placement of the actuators in the rosettes of lightings.



Installation of the actuator in the switch box in combination with a wireless switch.

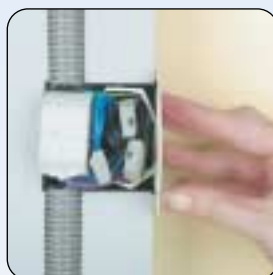

Installation of the actuator in the switch box or installation with lid.



Installation of the actuators in exterior and isolated boxes.



Installation of the actuator in cable channels



The batteries are easily replaced. Life duration of thermostat batteries is approximately 7 years.



Protection of the actuators with safety switch 16A, characteristic B.

### Control in socket outlets!

With aGenius, no particular intervention to the socket outlets of the building is needed in order to control different devices. You simply place the socket outlet with the incorporated actuator in the already installed conventional outlet.

### Battery Devices

The wireless components of aGenius contain a battery, which is easy to replace and must be changed approximately every 7 years for the thermostat and every 5 years for the remote control.

## PRODUCT LIST aGenius



### Home-Manager

Home Manager is a central display and operating device for wireless receipt and transmission of information. It accepts many inputs, commands or time scheduling and controls, in real time, many devices (heating, ventilation, lighting, blinds e.t.c). The management and programming can be made locally via a keyboard and an LCD display menu or distantly via phone (regular or mobile), a phone call or a computer modem. The frame is disposed separately.

6VA, 230VAC AHMU-00/01 70.01.01.006



### Switching Actuator ON/OFF

An output device 1x230VAC/8A for wireless activation of lighting, heating, alarm systems, etc.. The switching actuator turns on and off automatically devices, such as lighting, heating, alarm systems, etc.. Power supply is from the mains. The device can be mounted in installation boxes for switches, branch boxes or standard installation boxes, or directly in the rosette of the lighting.

8A/230VAC ASAU-01/01 70.01.01.001

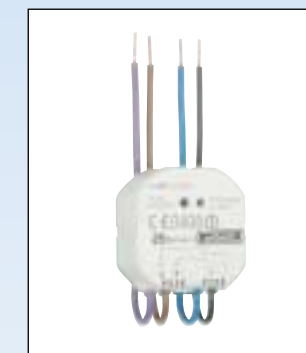

### Shutters/Blinds Actuator

An output device 1x230VAC/6A for wireless activation of shutter, blinds e.t.c The Shutters/Blinds Actuator controls shutters and blinds drives with 230 V motors. Power supply is from the mains. The device is mounted in installation boxes for switches or branch boxes.

6A/230VAC AJAU-01/02 70.01.01.012

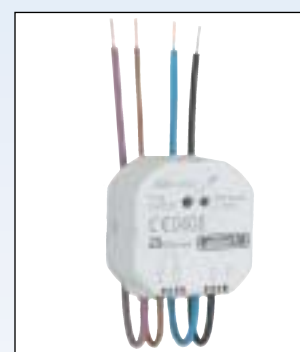

### Switching Actuator - potential - free

The "potential-free" switching actuator turns on and off automatically devices such as lighting, ventilation, alarm systems, etc. It is mains-supplied and can also switch voltages other than the supply voltage. The actuator can be incorporated into installation boxes for switches, branch boxes, standard installation boxes or directly in the lighting's rosette.

8A/230VAC ASAU-01/02 70.01.01.010



### Dimming Actuator

A dimming actuator device 1x230VAC/250VA with wireless activation for adjustment of the illumination of incandescent or halogen lamps.

250A/230VAC ADAU-01/01 70.01.01.002



### Switching Actuator - all-pole

The "all-pole" switching actuator turns on and off automatically devices such as lighting, ventilation, heating or alarm systems, etc. It is mains-supplied. Both the phase and the neutral conductor are being switched. The actuator can be incorporated into installation boxes for switches, branch boxes, standard installation boxes or directly in the lighting's rosette.

6A/230VAC ASAU-01/03 70.01.01.011

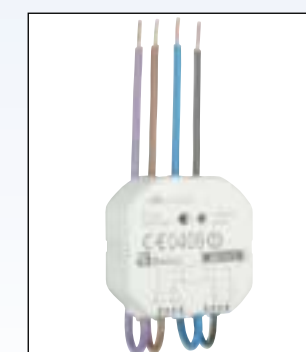

### Binary Input Unit 230V

A binary input unit 2x230VAC for wireless transmission from window contacts, motion detectors, relays, switches, pushbutton units, etc. The binary input unit transmits input signals e.g. from window contacts, motion detectors or other signal contacts (relays, switches, pushbutton units, etc.) to the convenient electrical installation system. Power supply is from the mains. The device can be mounted in installation boxes for switches, branch-off boxes or standard installation boxes.

2x230VAC ABEU-02/01 70.01.01.003

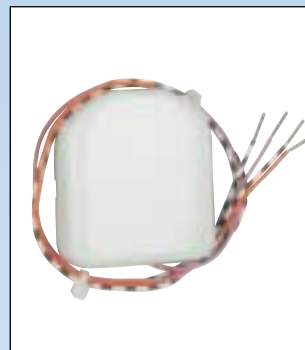

**Binary Input Unit**  
The binary input unit 2 x Signal Contact with wireless transmission from window contacts, motion sensors, relays, switches, pushbutton units, etc It controls any output device.

ABEU-02/02 70.01.01.004



**Switching Actuator Adapter Plug ON/OFF**  
The "Switching Actuator" adapter plug controls devices such as floorstanding lamps, fans, audio and video appliances, living room fountains, aquaria, etc. It is mains-supplied, can be plugged into an existing "wall outlet with side earthings" and does not require any wiring work.

8A/230VAC ASAP-01/01 70.01.01.015



**Temperature Input Unit**  
A temperature input unit -50 to +180°C by means of a temperature sensor for wireless transmission to the heating-ventilation system. The temperature sensor is not included.

2 x -50-180°C ATEU-02/01 70.01.01.005



**Dimming Actuator Adapter Plug with Side Earthings**  
The "Dimming Actuator" adapter plug controls and dims devices such as floor-standing lamps. It is mains-supplied, can be plugged into an existing "wall outlet with side earthings" and does not require any wiring work.

250VA/230VAC ADAP-01/01 70.01.01.016



**Single Push-button Unit**  
Single Push-button unit for wireless activation of devices (push the button up or down, instantly or extended). 10 years autonomy with a lithium battery included. It is combined with frames-rockers in a wide variety of designs and colours. The frames-rockers are not included.

ATAA-01/01 70.01.01.008



**Analogue Actuator 0-10VDC**  
The analogue actuator switches a relay and provides an output voltage of 0-10VDC for terminals such as mixers, heating, ventilation, dimmers, etc. The device is mains-supplied and can be incorporated into installation boxes, intermediate ceilings or directly into the devices to be controlled.

8A/230VAC AAAE-01/01 70.01.01.013



**Double Push-button Unit**  
Double Push-button unit for wireless activation of devices (push the button up or down, instantly or extended). 10 years autonomy with a lithium battery included. It is combined with frames-rockers in a wide variety of designs and colours. The frames-rockers are not included.

ATAA-02/01 70.01.01.009



**Analogue Actuator 1-10VDC**  
The analogue actuator switches a relay and actuates a control voltage of 1-10VDC for dimmers and electronic ballasts of fluorescent lamps. It is mains-supplied and can be incorporated into an installation box, an intermediate ceiling or directly into fluorescent lamps.

8A/230VAC AAAE-01/02 70.01.01.014



**Room Controller**  
Room controller 0 up to +40°C via an imbedded sensor for wireless transmission to the heating-ventilation system. The device is powered by two AAA batteries.

0 -40°C ARCA-00/01 70.01.01.007

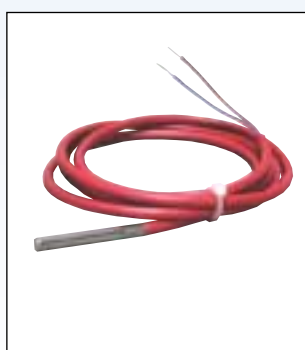

**Temperature Sensor**  
The temperature sensor detects the temperature for the temperature input unit. Depending on the application, the temperature sensor can be installed directly in the living room enclosure or the outdoor enclosure.

-50 to +180°C ASEZ-01/01 70.01.01.025



**Remote Control**  
The remote control sends signals to the actuators of the installation. This wireless device is powered by two AAA batteries. The batteries are included.

24 commands AHSZ-00/01 70.01.01.026



**Home Manager Cable**  
The cable 5m HM/SUBD for connection between the Home Manager and the frame connector for the wall outlet for communication with other devices.

5m AKAZ-05/01 70.01.01.035



**RS232 Interface**  
Electrical installation specialists will need the RS-232 interface in combination with a pocket PC for final adjustment of devices.

ARSZ-00/01 70.01.01.027



**SUBD/TM or Modem Cable**  
The cable 1,5m SUBD /TM connects the TV-module or the modem with the wall outlet of the Home Manager.

1,5m AKAZ-09/02 70.01.01.037

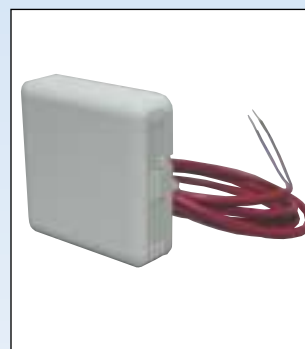

**Living Room Enclosure**  
The living room enclosure has been designed for using the temperature sensor for room temperature measurement. Sensor is not included.

80 x 84 x 23,5 mm  
ASEZ-01/02 70.01.01.030



**SUBD/PC Cable**  
The cable 1,5m SUBD/PC is used to set up a connection between the wall outlet or the TV-module device and the laptop/PC for configuring the Home Manager.

1,5m AKAZ-09/01 70.01.01.036



**Outdoor Enclosure**  
The outdoor enclosure has been designed for using the temperature sensor for outdoor temperature measurement. Sensor is not included.

80x84x23.5 mm  
ASEZ-01/03 70.01.01.031



**Scart Cable**  
The scart cable serves for connecting the TV-Module device to the TV set or video.

1,5m AKAZ-21/01 70.01.01.038



**Home Manager - Designer Frame**  
The designer frame can be mounted onto the Home Manager Comes without Home Manager.

SILVER-PLATED ALUMINIUM (ANODISED)  
AHMZ-01/01 70.01.01.033

ALUMINIUM RESEMBLING STAINLESS STEEL  
AHMZ-01/02 70.01.01.034



**Modem and Cable**  
The modem 56K with D +A cable establishes the connection between the telephone network and the Home Manager.

AKOZ-00/01 70.01.01.040



**RS-232 Cable for PDA**  
The cable is used to set up a connection between a pocket PC (Windows CE) and an RS232 wireless interface.

960mm ARSZ-00/02 70.01.01.041



**Cover Foil for glass - Grey**

80 x 80mm AMMZ-00/05 70.01.01.021



**Battery for Push-Button**

3V Li ABTZ-00/01 70.01.01.023



**RC-Unit**  
The RC-unit serves for limiting voltage peaks, which are produced when switching off by inductances integrated in the fluorescent lamps. It is recommended to attach with each fluorescent lamp a RC-unit. The RC-unit does not replace the conventional overvoltage protection!

250VAC AMMZ-00/07 70.01.01.022



**Battery for Binary Input and Temperature Input**

3V Li ABTZ-00/02 70.01.01.024



**Single rocker**

21.04.01.057

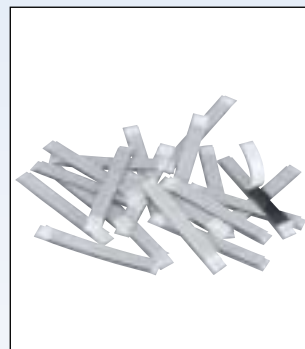

**Adhesive Strips**

1mm AMMZ-00/01 70.01.01.017



**Double rocker**

21.04.01.058



**Cover Foil for glass - White**

80 x 80mm AMMZ-00/04 70.01.01.020



**Frame**

21.04.01.059

WIRING EXAMPLES

WIRING EXAMPLES FOR SWITCHING ACTUATOR ASAU-01/01

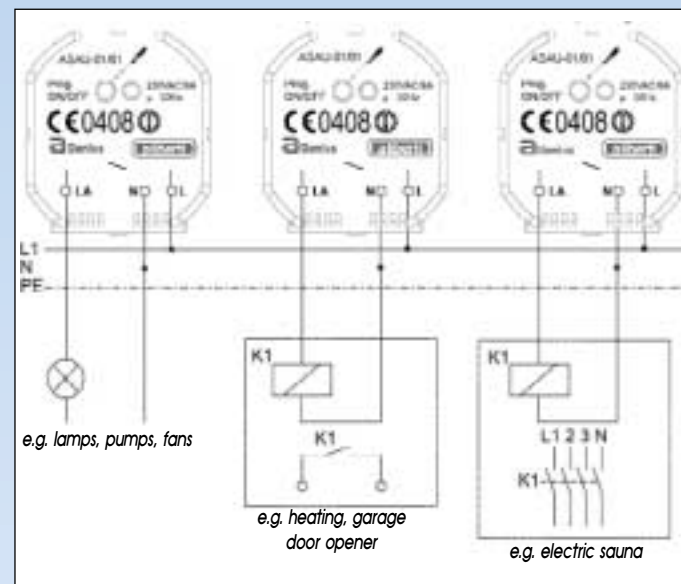

e.g. lamps, pumps, fans

e.g. heating, garage door opener

e.g. electric sauna

WIRING EXAMPLES FOR SWITCHING ACTUATOR ASAU-01/03

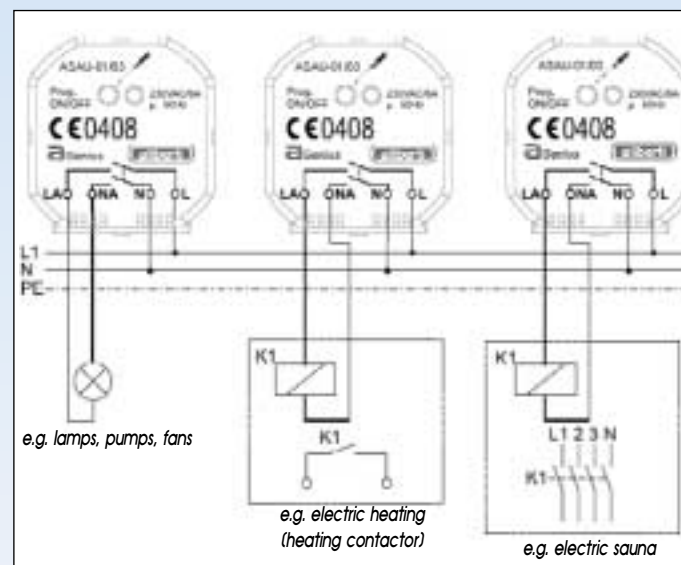

e.g. lamps, pumps, fans

e.g. electric heating (heating contactor)

e.g. electric sauna

WIRING EXAMPLES FOR DIMMING ACTUATOR ADAU-01/01

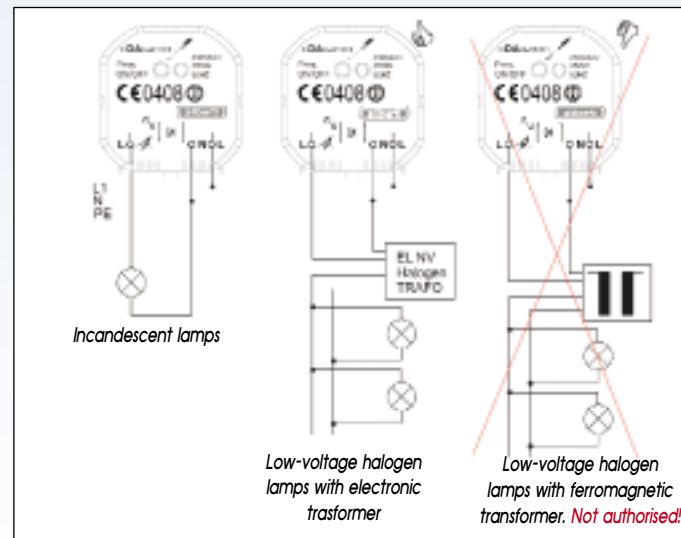

Incandescent lamps

Low-voltage halogen lamps with electronic transformer

Low-voltage halogen lamps with ferromagnetic transformer. **Not authorised!**

WIRING EXAMPLES FOR SWITCHING ACTUATOR ASAU-01/02

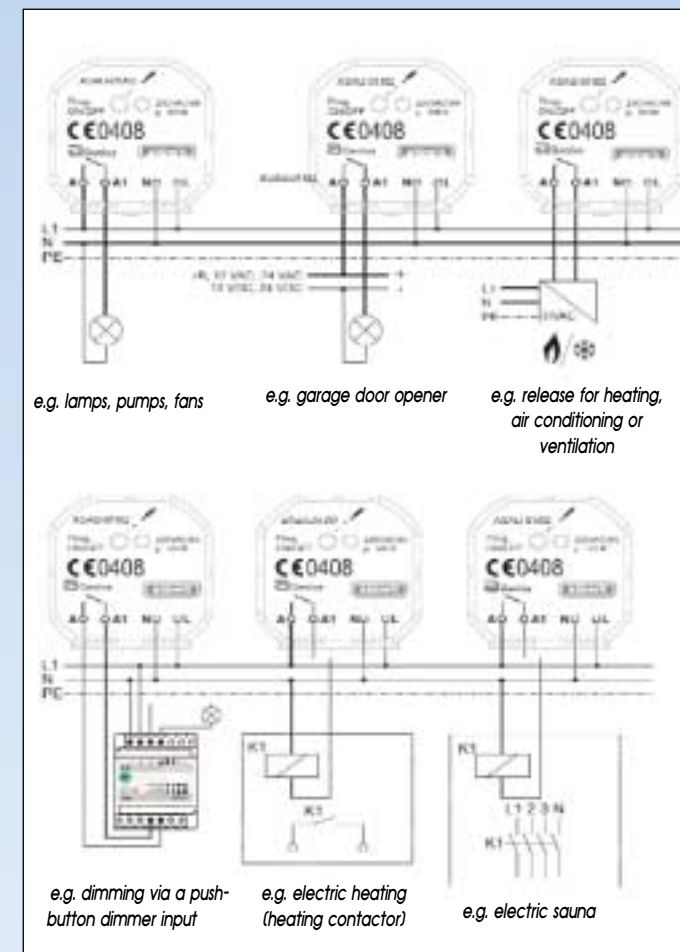

e.g. lamps, pumps, fans

e.g. garage door opener

e.g. release for heating, air conditioning or ventilation

e.g. dimming via a push-button dimmer input

e.g. electric heating (heating contactor)

e.g. electric sauna

WIRING EXAMPLES FOR ANALOGUE ACTUATOR AAAE-01/01

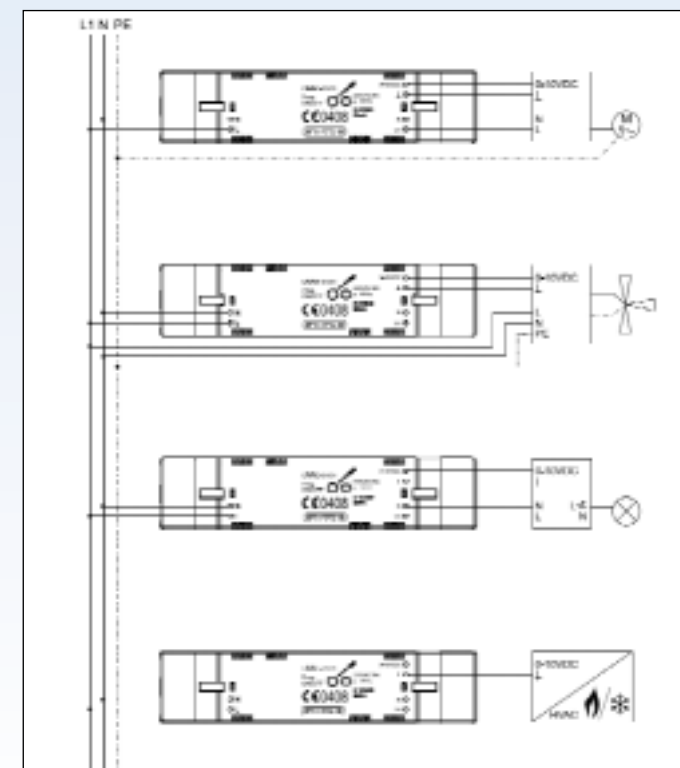

# WIRING EXAMPLES

## OVERVOLTAGE PROTECTION WITH INDUCTIVE LOADS - FLUORESCENT LAMPS

If is on the same phase with inductive load (e.g. fluorescent lamp) and switching actuator on/off, shutters or dimmer, an overvoltage protection is as in following examples to use.

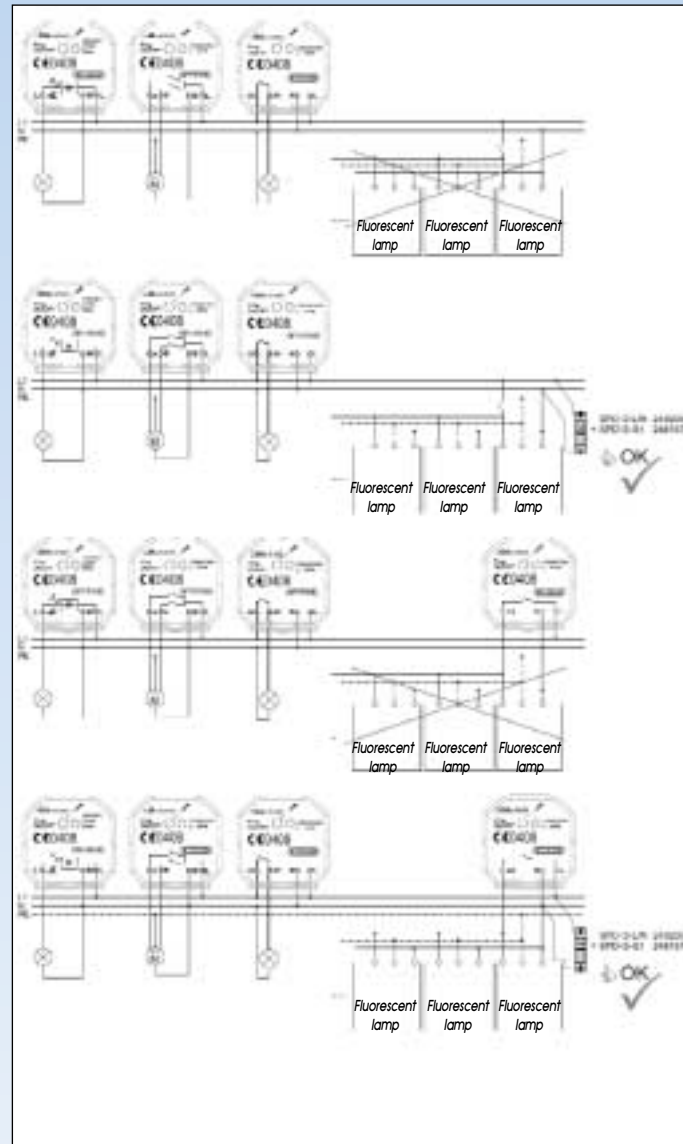
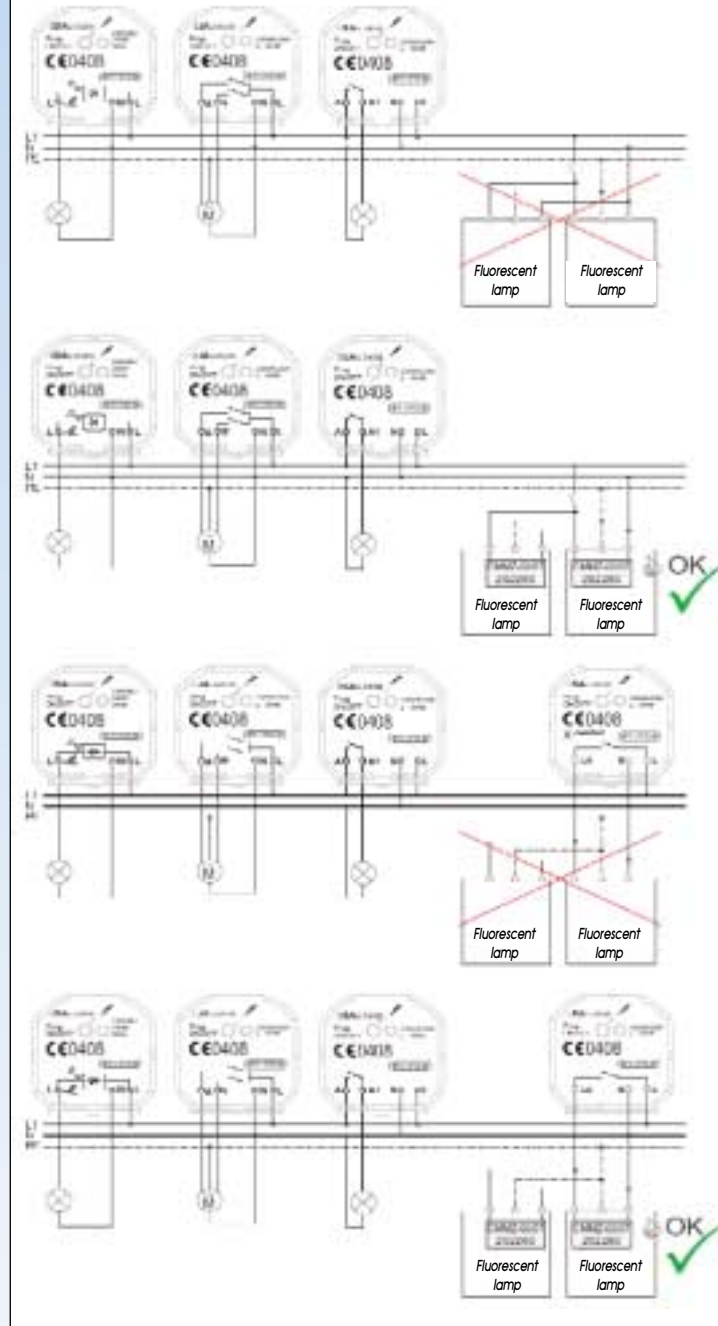

# WIRING EXAMPLES

## WIRING EXAMPLES FOR SHUTTER ACTUATOR AJAU-01/01

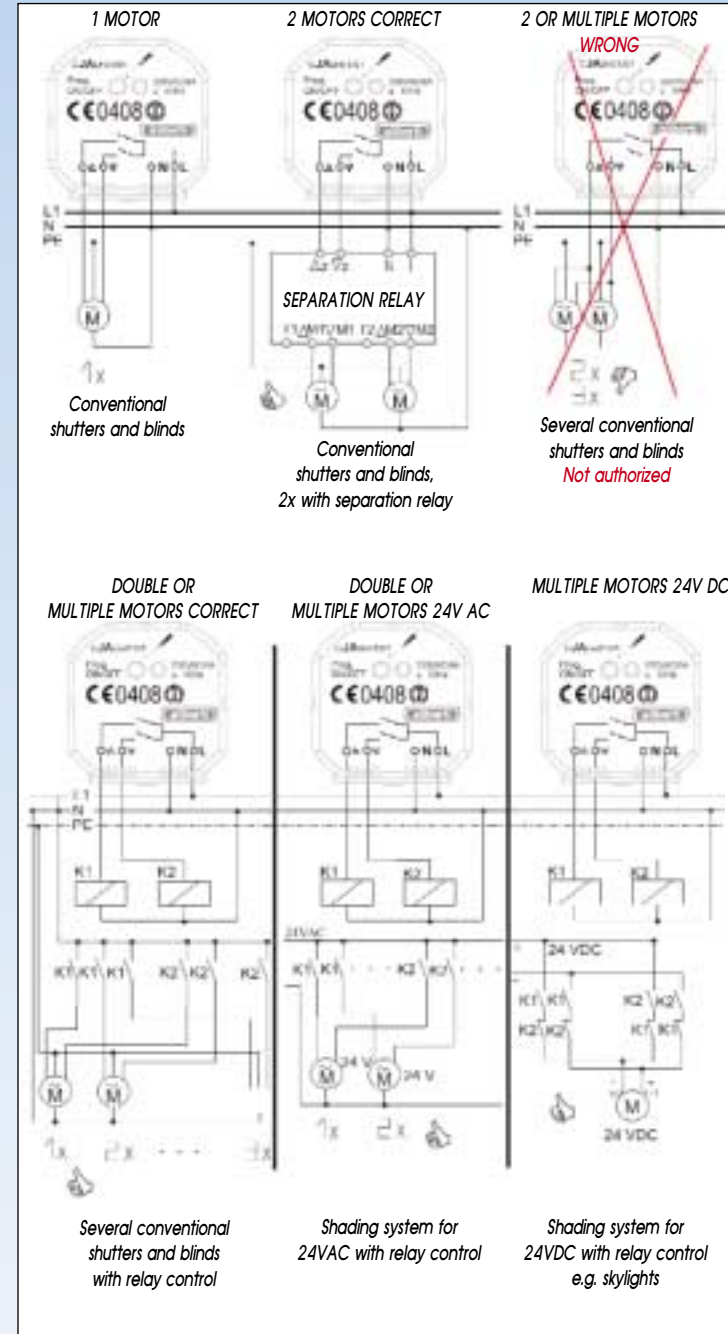

## WIRING EXAMPLES FOR BINARY INPUT CHANNEL 230 V

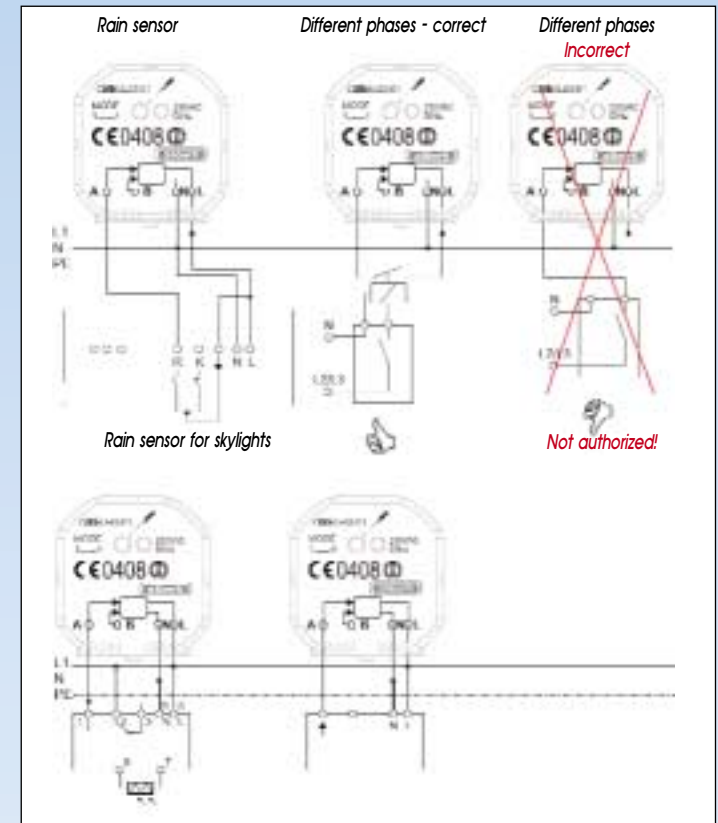

## WIRING EXAMPLES OF BINARY INPUT CHANNEL ABEU-02/01 (CONTINUED)

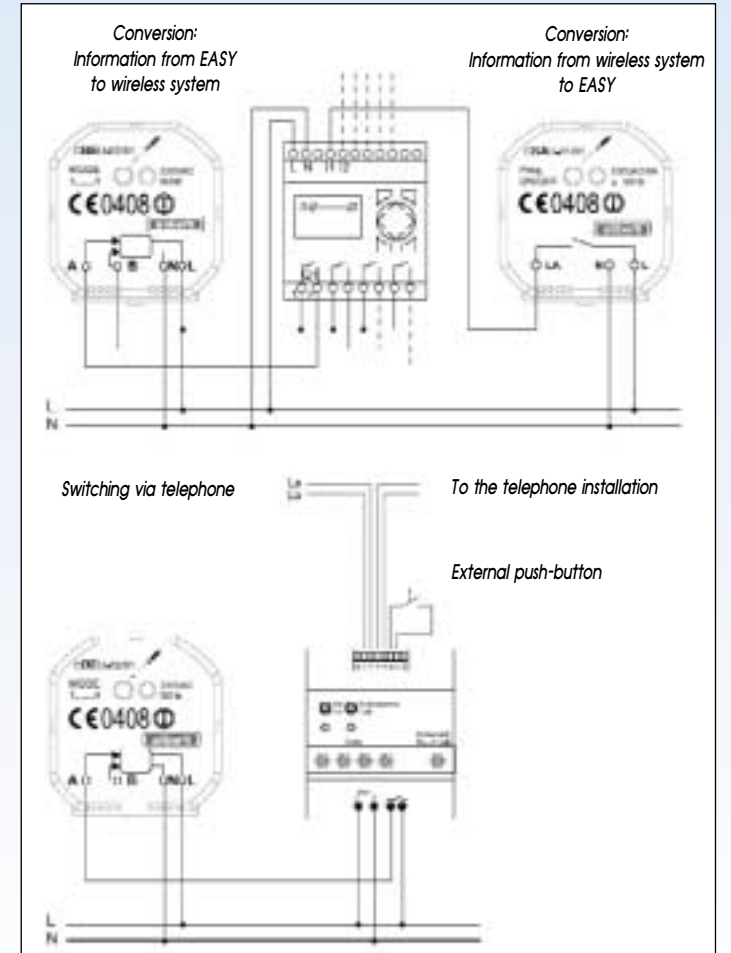

## WIRING EXAMPLES FOR ANALOGUE ACTUATOR AAAE-01/02.

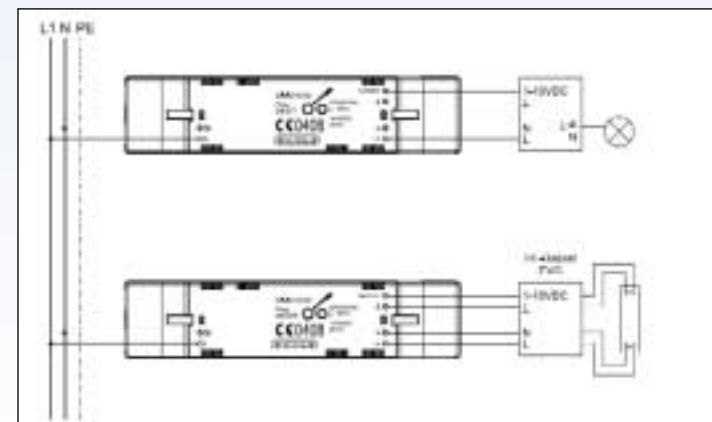

## TECHNICAL SPECIFICATIONS

In all elements stand the following common specifications:

FREQUENCY: 863.300MHz  
DEGREE OF PROTECTION: IP20  
DEGREE OF SOILING: 2

OPERATING TEMPERATURE: -5 to 45 °C  
STORAGE/TRANSPORTATION TEMPERATURE: -25 to 70 °C

### HOME MANAGER

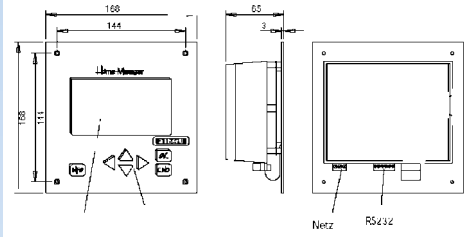

Power supply 230VAC/50Hz  
Protection 16A, characteristic B  
Type of transmission Bi-directional, via coded telegrams  
Indoor range Typically 30 – 50 m, 2 walls + 1 ceiling (depending on wall thickness and material!!)  
Color of the frame Grey, Ral 7035  
Dimension of the frame HxWxD 48,6x45,3x26,2mm  
Length of connection wires 150mm

### SWITCHING ACTUATOR ALL - POLES

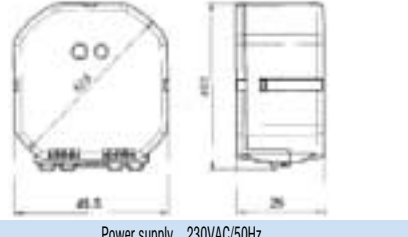

Power supply 230VAC/50Hz  
Connections Single-wired 1.5mm<sup>2</sup> connections  
Load 230VAC, 50Hz, 8A resistive load  
The device switches L via LA and N via NA  
Pre-protection Power circuit breaker 16A, characteristic B  
Internal protection through thermal protection  
Type of transmission Bi-directional, via coded telegrams  
Indoor range Typically 30 – 50 m, 2 walls + 1 ceiling (depending on wall thickness and material!!)  
Color of the frame Grey, Ral 7035  
Size of the frame HxWxD 48,6x45,3x26,2mm  
Length of connection wires 150mm

### BINARY INPUT CHANNEL

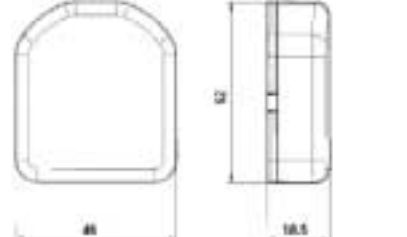

Power supply 230VAC, 50Hz  
Connections Single-wired 1.5mm<sup>2</sup> connections  
Input voltage Maximum 250V, 2 inputs  
As of 195Veff reliably ON, up to 110Veff reliably OFF  
Pre-protection Power circuit breaker 16A, characteristic B  
Type of transmission Bi-directional, via coded telegrams  
Indoor range Typically 30 – 50 m, 2 walls + 1 ceiling (depending on wall thickness and material!!)  
Color of the frame Grey, Ral 7035  
Size of the frame HxWxD 48,6x45,3x26,2mm  
Length of connection wires 150mm

### SWITCHING ACTUATOR ON/OFF

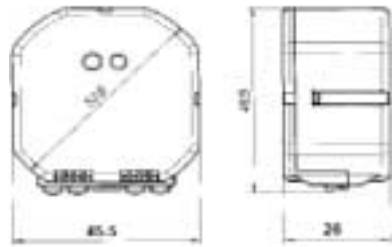

Power supply 230VAC/50Hz  
Connections Single-wired 1.5mm<sup>2</sup> connections  
Load 230VAC, 50Hz, 8A resistive load  
The device switches L via LA  
Pre-protection Power circuit breaker 16A, characteristic B  
Internal protection through thermal protection  
Type of transmission Bi-directional, via coded telegrams  
Indoor range Typically 30 – 50 m, 2 walls + 1 ceiling (depending on wall thickness and material!!)  
Color of the frame Grey, Ral 7035  
Size of the frame HxWxD 48,6x45,3x26,2mm  
Length of connection wires 150mm

### SHUTTER/BLINDS ACTUATOR

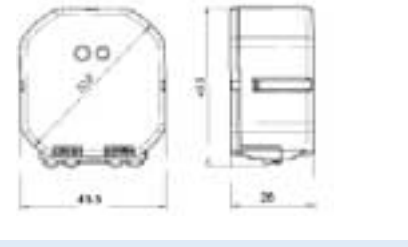

Power supply 230VAC/50Hz  
Connections Single-wired 1.5mm<sup>2</sup> connections  
Load 230VAC, 50Hz, 8A resistive load  
The device switches L via LA and N via NA  
Pre-protection Power circuit breaker 16A, characteristic B  
Internal protection through thermal protection  
Type of transmission Bi-directional, via coded telegrams  
Indoor range Typically 30 – 50 m, 2 walls + 1 ceiling (depending on wall thickness and material!!)  
Color of the frame Grey, Ral 7035  
Size of the frame HxWxD 48,6x45,3x26,2mm  
Length of connection wires 150mm

### BINARY INPUT CHANNEL WITH BATTERY

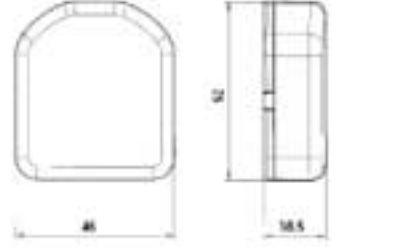

Power supply 3V via CR2477 N battery  
Connections 4-pole terminal strip or 4-pole terminal strip with set of cables. The binary input channel measures the contact resistance up to max. 220Ω ON, and as of 10kΩ min. OFF  
Type of transmission Bi-directional, via coded telegrams  
Indoor range Typically 30 – 50 m, 2 walls + 1 ceiling (depending on wall thickness and material!!)  
Service life of the battery Approx. 5-7 years depending on application and type of battery  
Color of the frame White, similar to Ral9010  
Dimensions of the frame HxWxD 51x46x18mm

### SWITCHING ACTUATOR VOLTAGE - FREE

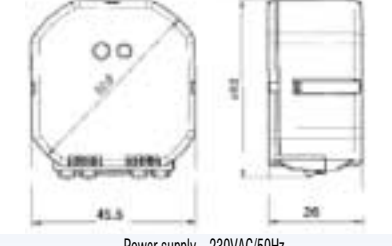

Power supply 230VAC/50Hz  
Connections Single-wired 1.5mm<sup>2</sup> connections  
Load 230VAC, 50Hz, 8A resistive load; 24VDC, 8A  
The device switches A via A1  
Pre-protection Power circuit breaker 16A, characteristic B  
Internal protection through thermal protection  
Type of transmission Bi-directional, via coded telegrams  
Indoor range Typically 30 – 50 m, 2 walls + 1 ceiling (depending on wall thickness and material!!)  
Color of the frame Grey, Ral 7035  
Size of the frame HxWxD 48,6x45,3x26,2mm  
Length of connection wires 150mm

### DIMMING ACTUATOR

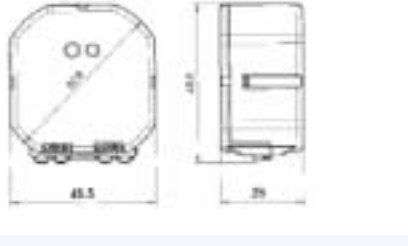

Power supply 230VAC/50Hz  
Connections Single-wired 1.5mm<sup>2</sup> connections  
Load 230VAC, 50Hz, 250W incandescent lamps or electronic transformers, reversed phase control  
Pre-protection Power circuit breaker 16A, characteristic B  
Internal overload and short-circuit protection  
Type of transmission Bi-directional, via coded telegrams  
Indoor range Typically 30 – 50 m, 2 walls + 1 ceiling (depending on wall thickness and material!!)  
Color of the frame Grey, Ral 7035  
Size of the frame HxWxD 48,6x45,3x26,2mm  
Length of connection wires 150mm

### TEMPERATURE INPUT UNIT



Power supply 3V via CR2477 N battery  
Connections 4-pole terminal strip inputs for ASEZ-01/01  
Type of transmission Bi-directional, via coded telegrams  
Indoor range Typically 30 – 50 m, 2 walls + 1 ceiling (depending on wall thickness and material!!)  
Service life of the battery Approx. 5-7 years depending on application and type of battery  
Color of the frame White, similar to Ral9010  
Dimensions of the frame HxWxD 51x46x18mm

## TECHNICAL SPECIFICATIONS

### PUSH-BUTTON

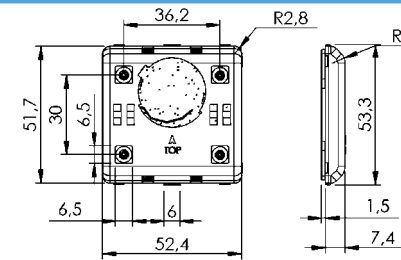

Power supply 3V via CR2430 battery  
Number of rockers depending on type  
Type of transmission Bi-directional, via coded telegrams  
Indoor range Typically 30 – 50 m, 2 walls + 1 ceiling (depending on wall thickness and material!!)  
Service life of the battery Approx. 10 years (= battery life) depending on application and type of battery  
Color of the frame White, similar to Ral9010

### ANALOGUE ACTUATOR 0-10VDC

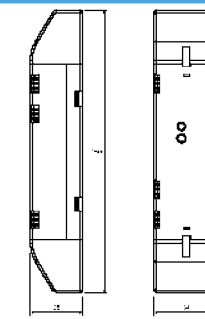

Power supply 230VAC, 50Hz  
Connections Single-wired 1.5mm<sup>2</sup> connections  
Load 230VAC, 50Hz, 8A resistive load  
The device switches L via LA  
Internal protection through thermal Protection  
Pre-protection Power circuit breaker 16A, characteristic B  
Control output 0-10VDC, max. 20mA  
internal electronic overload protection  
Type of transmission Bi-directional, via coded telegrams  
Indoor range Typically 30 – 50 m, 2 walls + 1 ceiling (depending on wall thickness and material!!)  
Color of the frame Grey, Ral 7035  
Size of the frame HxWxD 150x34x28mm

### HAND-HELD TRANSMITTER

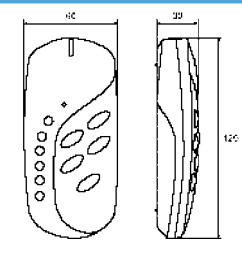

Power supply 3V via 2x LR03 (AAA)  
Channels 6 x 2 = 12 (24 functions)  
Status - LED  
Type of transmission Bi-directional, via coded telegrams  
Indoor range Typically 30 – 50 m, 2 walls + 1 ceiling (depending on wall thickness and material!!)  
Service life of the battery Approx. 3-5 years depending on application and type of battery  
Color of the frame Graphite-grey, similar to RAL7024  
Dimensions HxWxD - 120x60x30mm

### ACTUATOR ADAPTER PLUG WITH SIDE EARTHING

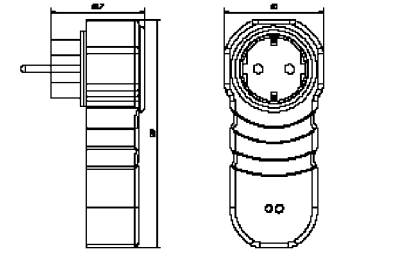

Power supply 230VAC, 50Hz  
Plug system Side earthing, with children protection  
Load 230VAC, 50Hz, 8A resistive load  
Internal protection through thermal protection  
Pre-protection Power circuit breaker 16A, characteristic B  
Type of transmission Bi-directional, via coded telegrams  
Indoor range Typically 30 – 50 m, 2 walls + 1 ceiling (depending on wall thickness and material!!)  
Color of the frame White, similar to Ral9016  
Size of the frame HxWxD - 138x60xapprox.57mm  
Approval Printed onto the device

### ANALOGUE ACTUATOR 1-10VDC

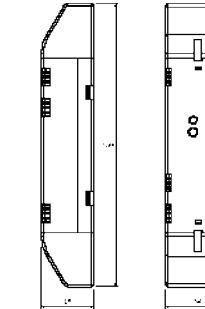

Power supply 230VAC, 50Hz  
Connections Single-wired 1.5mm<sup>2</sup> connections  
Load 230VAC, 50Hz, 8A resistive load  
The device switches L via LA  
Internal protection through thermal Protection  
Pre-protection Power circuit breaker 16A, characteristic B  
Control output 1-10VDC, max. 20mA  
internal electronic overload protection  
Type of transmission Bi-directional, via coded telegrams  
Indoor range Typically 30 – 50 m, 2 walls + 1 ceiling (depending on wall thickness and material!!)  
Color of the frame Grey, Ral 7035  
Size of the frame HxWxD 150x34x28mm

### RS232 INTERFACE

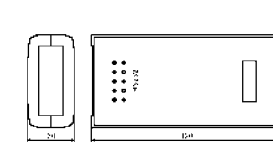

Power supply Via storage-battery pack  
Connections 12VDC jack, 140 mA  
Data via 9-pole SUBD 3 Status LEDs  
Type of transmission Bi-directional, via coded telegrams  
Indoor range Typically 30 – 50 m, 2 walls + 1 ceiling  
Independence of storage batt. Approx. 6h in permanent service  
Color of the frame Grey, similar to RAL7035  
Overall dimensions LxWxD - 120x60x30mm

### DIMMING ACTUATOR ADAPTER PLUG WITH SIDE EARTHING

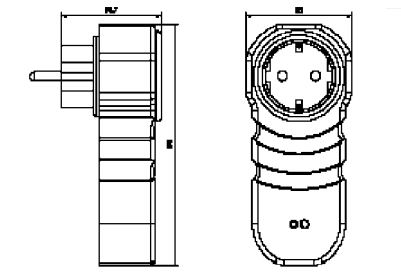

Power supply 230VAC, 50Hz  
Plug system Side earthing, with children protection  
Load 230VAC, 50Hz, 250W incandescent lamps or electronic transformers. Reserved phase control. Internal overload and short-circuit protection  
Pre-protection Power circuit breaker 16A, characteristic B  
Type of transmission Bi-directional, via coded telegrams  
Indoor range Typically 30 – 50 m, 2 walls + 1 ceiling (depending on wall thickness and material!!)  
Color of the frame White, similar to Ral9016  
Size of the frame HxWxD - 138x60xapprox.57mm  
Approval Printed onto the device

### TEMPERATURE SENSOR

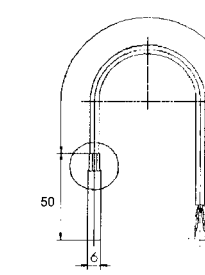

Power supply Via temperature input channel  
Cable Silicone, black  
2x 0.25mm<sup>2</sup>, 1m  
Measuring sleeve Stainless steel, diam. = 6mm, l=50mm  
Measuring range -50 to +180 °C  
Sensor element PT1000

### ROOM TEMPERATURE CONTROL

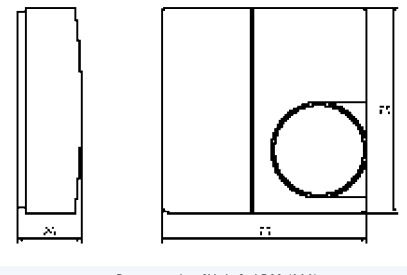

Power supply 3V via 2x LR03 (AAA)  
Temperature range 0 – 40°C  
Basic setting 21°C, +/-3 °C to be changed with an adjusting wheel  
Type of transmission Bi-directional, via coded telegrams  
Indoor range Typically 30 – 50 m, 2 walls + 1 ceiling (depending on wall thickness and material!!)  
Service life of the battery Approx. 5-7 years depending on application and type of battery  
Color of the frame White, similar to RAL9010  
Dimensions HxWxD - 75x75x26mm

***Even from there  
you can take care  
of your place with safety***



**aGenius**  
THE FUTURE IS WIRELESS



[www.aliberti.gr](http://www.aliberti.gr) • e-mail: [aliberti@aliberti.gr](mailto:aliberti@aliberti.gr)